

THIS MAP WAS PREPARED FOR ASSESSMENT PURPOSE ONLY

S.E.1/4 N.W.1/4 SEC.4 T.4N. R.1W. W.M.

04 01 04 BD
ST. HELENS

COLUMBIA COUNTY

1" = 100'

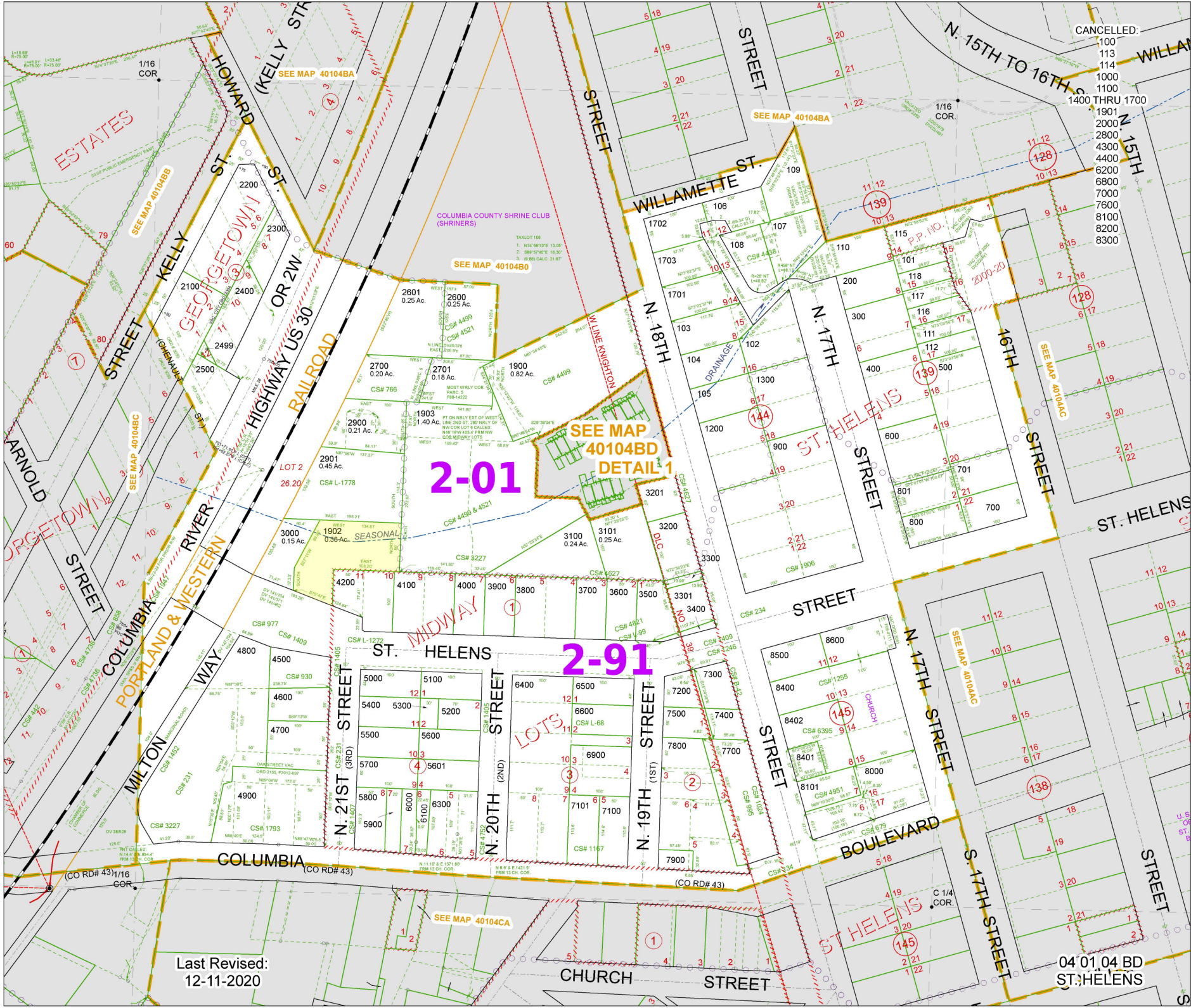

Last Revised:
12-11-2020

04 01 04 BD
ST. HELENS